

PARCEL DATA

Parcel	866140-0050
Name	ANDERSON JOHN M+NIKKOLE B
Site Address	5336 BUTTERWORTH RD 98040
Residential Area	097-004 (SE Appraisal District)
Property Name	

Jurisdiction	MERCER ISLAND
Levy Code	1031
Property Type	R
Plat Block / Building Number	
Plat Lot / Unit Number	5
Quarter-Section-Township-Range	NE-19-24-5

Legal Description

TONJA ESTATES TGW UND 1/4 INT IN TRACT A OF SD PLAT PLat Block: Plat Lot: 5

LAND DATA

Highest & Best Use As If Vacant	SINGLE FAMILY
Highest & Best Use As Improved	PRESENT USE
Present Use	Single Family(Res Use/Zone)
Land SqFt	25,459
Acres	0.58

Percentage Unusable	
Unbuildable	NO
Restrictive Size Shape	NO
Zoning	R-15
Water	WATER DISTRICT
Sewer/Septic	PUBLIC
Road Access	PRIVATE
Parking	ADEQUATE
Street Surface	PAVED

Views

Rainier	GOOD
Territorial	EXCELLENT
Olympics	
Cascades	
Seattle Skyline	
Puget Sound	
Lake Washington	EXCELLENT
Lake Sammamish	
Lake/River/Creek	
Other View	

Waterfront

Waterfront Location	LAKE WASH
Waterfront Footage	77
Lot Depth Factor	0
Waterfront Bank	LOW
Tide/Shore	UPLANDS WITH TIDELANDS/SHORELANDS
Waterfront Restricted Access	
Waterfront Access Rights	NO
Poor Quality	NO
Proximity Influence	NO

Designations

Historic Site	
Current Use	(none)
Nbr Bldg Sites	
Adjacent to Golf Fairway	NO
Adjacent to Greenbelt	NO
Other Designation	NO
Deed Restrictions	NO
Development Rights Purchased	NO
Easements	NO
Native Growth Protection Easement	NO
DNR Lease	NO

Nuisances

Topography	
Traffic Noise	
Airport Noise	
Power Lines	NO
Other Nuisances	NO

Problems

Water Problems	NO
Transportation Concurrency	NO
Other Problems	NO

Environmental

Environmental	YES
---------------	-----

Environmental Type	Information Source	Delineation study	Percentage Affected
Stream	JURISDICTION	N	60

BUILDING

Building Number	1
Year Built	2000
Year Renovated	0
Stories	2
Living Units	2
Grade	11 Excellent
Grade Variant	0
Condition	Good
Basement Grade	11 Excellent



Click the camera to see more pictures.

1st Floor	2,850
1/2 Floor	0
2nd Floor	2,680
Upper Floor	0
Finished Basement	1,880
Total Finished Area	7,410
Total Basement	1,880
Basement Garage	0
Unfinished 1/2	0
Unfinished Full	0
AGLA	5,530
Attached Garage	790
Bedrooms	5
Full Baths	3
3/4 Baths	1
1/2 Baths	1
Heat Source	Gas
Heat System	Forced Air
Deck Area SqFt	770
Open Porch SqFt	240
Enclosed Porch SqFt	0
Brick/Stone	10
Fireplace Single Story	0
Fireplace Multi Story	1
Fireplace Free Standing	0
Fireplace Additional	1
AddnlCost	0
Obsolescence	0
Net Condition	0
Percentage Complete	0
Daylight Basement	YES
View Utilization	

Picture of Building 1



Floor plan of Building 1

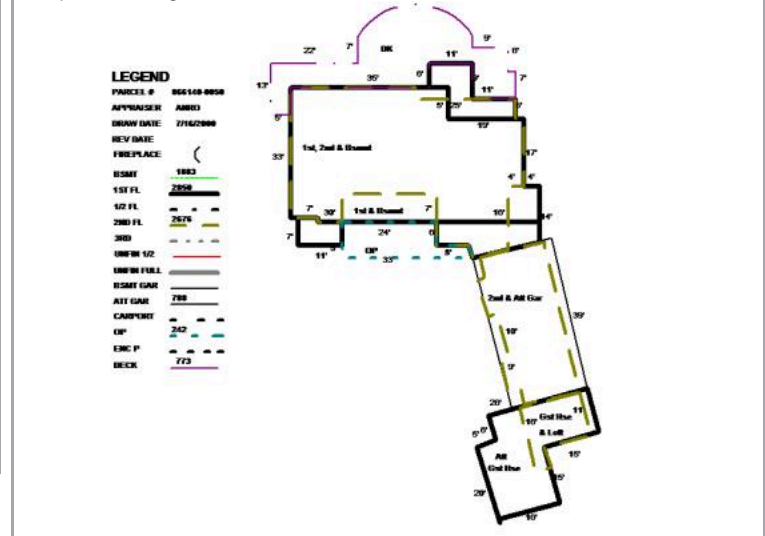

Accessory Of Building Number: 1

Accessory Type	Picture	Description	SqFt	Grade	Eff Year	%	Value	Date Valued
MISC IMP		Avg dock/1 boat lift	650				68000	10/16/2024

TAX ROLL HISTORY

Account	Valued Year	Tax Year	Omit Year	Levy Code	Appraised Land Value (\$)	Appraised Imps Value (\$)	Appraised Total Value (\$)	New Dollars	Taxable Land Value (\$)	Taxable Imps Value (\$)	Taxable Total Value (\$)	Tax Value Reason
866140005004	2025	2026		1031	4,795,000	2,895,000	7,690,000	0	4,795,000	2,895,000	7,690,000	
866140005004	2024	2025		1031	2,817,000	3,575,000	6,392,000	0	2,817,000	3,575,000	6,392,000	
866140005004	2023	2024		1031	2,658,000	3,345,000	6,003,000	0	2,658,000	3,345,000	6,003,000	
866140005004	2022	2023		1031	2,991,000	3,723,000	6,714,000	0	2,991,000	3,723,000	6,714,000	
866140005004	2021	2022		1031	2,462,000	2,556,000	5,018,000	0	2,462,000	2,556,000	5,018,000	
866140005004	2020	2021		1031	2,345,000	2,086,000	4,431,000	0	2,345,000	2,086,000	4,431,000	
866140005004	2019	2020		1031	1,792,000	2,940,000	4,732,000	0	1,792,000	2,940,000	4,732,000	
866140005004	2018	2019		1031	1,829,000	3,031,000	4,860,000	0	1,829,000	3,031,000	4,860,000	
866140005004	2017	2018		1031	1,759,000	2,932,000	4,691,000	0	1,759,000	2,932,000	4,691,000	
866140005004	2016	2017		1031	1,608,000	2,614,000	4,222,000	0	1,608,000	2,614,000	4,222,000	
866140005004	2015	2016		1031	1,456,000	2,368,000	3,824,000	137,000	1,456,000	2,368,000	3,824,000	
866140005004	2014	2015		1031	1,346,000	1,378,000	2,724,000	0	1,346,000	1,378,000	2,724,000	
866140005004	2013	2014		1031	1,721,000	1,923,000	3,644,000	0	1,721,000	1,923,000	3,644,000	
866140005004	2012	2013		1031	1,587,000	1,773,000	3,360,000	0	1,587,000	1,773,000	3,360,000	
866140005004	2011	2012		1031	1,669,000	1,860,000	3,529,000	0	1,669,000	1,860,000	3,529,000	
866140005004	2010	2011		1031	1,748,000	1,948,000	3,696,000	0	1,748,000	1,948,000	3,696,000	
866140005004	2009	2010		1031	1,800,000	2,004,000	3,804,000	0	1,800,000	2,004,000	3,804,000	
866140005004	2008	2009		1031	2,051,000	2,284,000	4,335,000	0	2,051,000	2,284,000	4,335,000	
866140005004	2007	2008		1031	1,394,000	2,369,000	3,763,000	0	1,394,000	2,369,000	3,763,000	
866140005004	2006	2007		1031	1,245,000	2,272,000	3,517,000	0	1,245,000	2,272,000	3,517,000	
866140005004	2005	2006		1031	1,132,000	2,061,000	3,193,000	0	1,132,000	2,061,000	3,193,000	
866140005004	2004	2005		1031	1,039,000	1,868,000	2,907,000	0	1,039,000	1,868,000	2,907,000	
866140005004	2003	2004		1031	1,039,000	1,868,000	2,907,000	0	1,039,000	1,868,000	2,907,000	

866140005004	2002	2003		1031	1,039,000	1,868,000	2,907,000	0	1,039,000	1,868,000	2,907,000	
866140005004	2001	2002		1031	839,000	1,007,000	1,846,000	459,000	839,000	1,007,000	1,846,000	
866140005004	2000	2001		1031	730,000	478,000	1,208,000	399,000	730,000	478,000	1,208,000	
866140005004	1999	2000		1031	609,000	349,000	958,000	0	609,000	349,000	958,000	
866140005004	1998	1999		1031	580,000	333,000	913,000	0	580,000	333,000	913,000	
866140005004	1997	1998		1031	0	0	0	0	725,000	53,000	778,000	
866140005004	1996	1997		1031	0	0	0	0	725,000	50,000	775,000	
866140005004	1995	1996		1031	0	0	0	0	725,000	50,000	775,000	

SALES HISTORY

Excise Number	Recording Number	Document Date	Sale Price	Seller Name	Buyer Name	Instrument	Sale Reason
<u>2333609</u>	<u>20080221002126</u>	2/15/2008	\$6,500,000.00	SMITH W GRAHAM	ANDERSON JOHN M+NIKKOLE B	Statutory Warranty Deed	None
<u>2130893</u>	<u>20050615001045</u>	6/13/2005	\$0.00	SMITH ANITA C	SMITH W GRAHAM	Quit Claim Deed	Property Settlement
<u>2079264</u>	<u>20041026002109</u>	10/19/2004	\$4,200,000.00	-ROSA JANET PER REP+WRIGHT JOSEPHINE S - EST OF	SMITH W GRAHAM+AMITA C	Statutory Warranty Deed	Estate Settlement
<u>2047372</u>	<u>20040616002378</u>	6/10/2004	\$4,500,000.00	JAMERSON KRISTIN A	WRIGHT JOSEPHINE S	Statutory Warranty Deed	Estate Settlement
<u>1674569</u>	<u>199903251996</u>	3/22/1999	\$1,225,000.00	SCHOENFELD ALVIN E+RUTH M	JAMERSON JOHN E+KRISTIN A	Statutory Warranty Deed	None

REVIEW HISTORY

PERMIT HISTORY

Permit Number	Permit Description	Type	Issue Date	Permit Value	Issuing Jurisdiction	Reviewed Date
<u>2509-127</u>	1 Service Change 1-200 amps, 3 Air Conditioner - circuit,		9/15/2025	\$0	MERCER ISLAND	
<u>1910-073</u>	REPLACE DECKING W/NEW SURFACE, REDUCE INSHORE WIDTH,	Remodel	9/18/2020	\$175,505	MERCER ISLAND	8/30/2021
<u>1712-138</u>	1 GENERATOR- OUTSIDE,		12/11/2017	\$0	MERCER ISLAND	6/5/2018
<u>1606-033</u>	RPBA PREMEIS ISOLATION,		6/3/2016	\$0	MERCER ISLAND	9/15/2016
<u>1406-089</u>	RELOCATE FOUR HEADS, ADDING THREE,	Other	6/10/2014	\$0	MERCER ISLAND	7/16/2015
<u>1405-112</u>	KITCHEN REMODEL,	Remodel	5/14/2014	\$87,500	MERCER ISLAND	7/16/2015
<u>0411-237</u>	Interior alterations	Remodel	11/22/2004	\$50,000	MERCER ISLAND	7/12/2005
<u>0006-050</u>	Inground gunite spa	Accessory, New	7/26/2000	\$15,000	MERCER ISLAND	9/13/2001
<u>9908132</u>	Remodel of existing & a 3450 sq. ft. addition	Remodel	11/1/1999	\$705,392	MERCER ISLAND	9/13/2001

HOME IMPROVEMENT EXEMPTION

Exempt Number	Building Number	Received Date	Estimated Cost	Estimated Completion Date	Begin Year	End Year	Amount	Permit Jurisdiction
27226	1	4/11/2005	\$225,000	5/30/2005	0	0	\$0	MERCER ISLAND